

ENERGEN

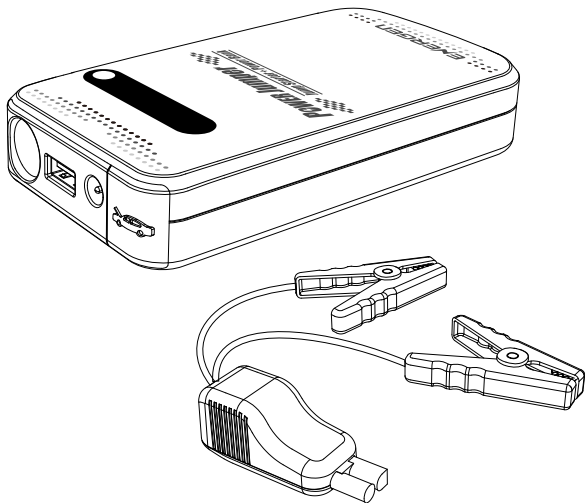

Power Jumper P4

USER MANUAL AND SAFETY GUIDELINE

Thank you for choosing **ENERGEN** Power Jumper.
Please always follow basic safety precautions when using electrical appliances. Read all instructions carefully and please keep this instruction manual for easy reference.

Model : EN-PJP4WH/EN-PJP4BK

Product Instructions :

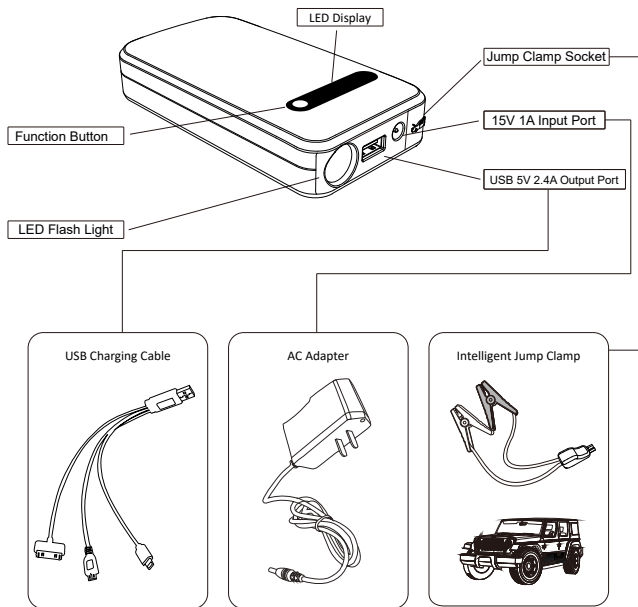

A. Operation Guidance:

To turn on:

Press "Function Button" once, then press and hold for 3 seconds, and LED Display shows "ON".

To turn off:

When USB devices is fully charged or no USB connection is detected.

Power Jumper Charging Instruction:

To charge Power Jumper, connect the AC adapter to wall outlet and Power Jumper.

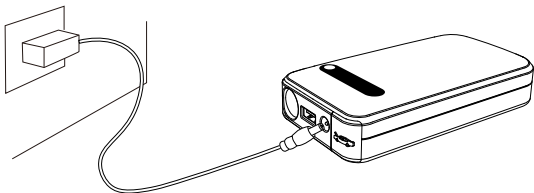

B. Jump Start Procedure:

01. Make sure Power Jumper has at least 60% battery level.
02. Securely connect the jump clamp to jump clamp socket.
03. Securely connect the positive (+) red clamp to the positive (+) terminal of the vehicle battery and securely connect the negative (-) black clamp to the negative (-) terminal of the vehicle battery.
04. Turn on power jumper by click function button once, then press and hold for 3 seconds.
05. When the clamps are properly connected to the vehicle battery, the status indicator of intelligent jump clamp will illuminate a solid green. It's ready to jump start your vehicle.
06. If wrongly connect the positive (+) red clamp to negative (-) terminal of the battery, and negative (-) black clamp to positive (+) terminal of the battery, the Power Jumper will shut off immediately to protect the power Jumper and vehicle. Meanwhile the intelligent jump clamp start beeping.

07. Start the vehicle. Do not crank the ignition more than 3 seconds. If vehicle doesn't start, wait about 1 minute and try again. If engine dose not start after second attempt, discontinue cranking and consult a professional.
08. After the engine starts, please remove the jump clamp from the battery.
09. Store the Power Jumper in a cool, dry environment, away from flammable material. Remember to re-charge Power Jumper every three months.

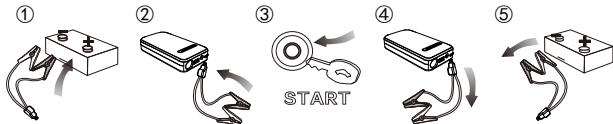

After connecting the jump clamps, check the LED indicator:

	Green: Power jumper is ready to jump start your vehicle.
	No Light: Press the "Enforce Button". Then start your vehicle within 30 seconds.
	No Light with Beep Sound: Please reverse the jump clamps connection.

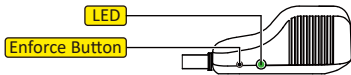

C. Charging Cell Phone, Tablet and USB device Instruction:

01. Plug the USB charging cable to USB 5V/2.4A output port.
02. Select appropriate connector for your USB device and connect it. Power Jumper can identify and charge the device automatically.
03. Click "Function Button" once, press and hold for 3 seconds to turn on power jumper and start charging, then the LED display will be on when the device is charging.

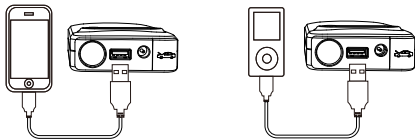

D. Using LED Flash Light:

Click "Function Button" once, press and hold for 3 seconds to turn on power jumper first, then press function button and hold 3 seconds to start the LED flash light.

There are 4 modes of flash light (ON, Strobe, SOS, OFF). You can switch each mode by clicking the "Function Button".

E. Parts List:

#	Parts Name	Quantity
1	Power Jumper	1
2	Jump Clamps	1
3	USB Charging Cable	1
4	User Manual	1
5	AC Adapter	1

F. Technical Specifications:

Model Number : EN-PJP4-BK / EN-PJP4-WH
Weight : 0.64LB / 290G
Battery Capacity : 10000mAh
Battery Life : Cycles < 500
Outputs : USB 5V / 2.4A
Input : AC100-240V, DC15V / 1A
Jump Start Current : Peak 400A
Charging Time : Charging Times Approx. 2.5hrs
Operation Temp : -4~140°F / -20°C - 60°C
LED Energy : 1W
Dimensions : 5.4 × 2.8 × 1.1 inch / 138 × 72 × 27 mm

G. FAQ:

Q. How to turn off Power Jumper?

A. Power Jumper will power off automatically when no load or charging.

Q. How many times can Power Jumper charge my cell phone?

A. Approx. 1~2 times for iPhone 6.

Q. How long does it take to charge my cell phone in full via Power Jumper?

A. Approx. 1 hour.

Q. How long the battery power will remain in Power Jumper?

A. Approx. 3~6 months, we recommend to recharge every 3 months.

H. Trouble Shooting

Finding	Cause	Solution
No response when pressing the FUNCTION button.	Low Voltage Protection of Power Jumper is activated.	Connect the AC adapter into 15V 1A input port to reset.

I. Toxic and Harmful Substances

Composition and amount of toxic and harmful substance in Power Jumper					
Pb	Hg	Cd	Cr(Vi)	PBB	PBDE
0	0	0	0	0	0
0:Indicate all homogeneous materials's hazardous substances content are below the MCV limit specified in the standard 2002/95/EC (RoHs)					

J. Warning

01. After jump started your vehicle, please disconnect Power Jumper from your vehicle battery within 30 seconds.
02. Do Not connect Jump clamps positive (+) and negative (-) clip together, it may cause danger.
03. Do Not disassemble this product, it may cause danger.

K. Safety Guideline

- ⚠ Always be cautious when using Power Jumper and avoid operating Power Jumper unattended. Please remain in constant observation to monitor the charging process for any potential problems that may occur.
- 🚫 The Power Jumper is not intended for use by children under 18 without adult supervision.
- 🚫 The Power Jumper is neither water-resistant nor water proof. Do not splash, put in contact with or submerge in water.
- 🚫 Do not operate the Power Jumper near open flame, compressed gas canisters or flammable liquids.
- 🚫 Do not open the chassis or disassemble the Power Jumper. Modifying or tampering with Power Jumper's internal components can cause a malfunction and will void its warranty. If your Power Jumper is not performing as it should, contact with our technical support for assistance.
- ⚠ Keep the product away from extreme heat or cold.
- ⚠ Please avoid dropping, hitting or throwing the Power Jumper.
- 🚫 Do not store where the temperature may exceed 104°F.
- ⚠ Charge Power Jumper or only at ambient temperature between 23°F ~104°F
- ⚠ Under extreme conditions, battery leakage may occur. Carefully wipe the liquid off by using a cloth and avoid skin contact when you notice liquid on the batteries. In case of skin or eye contact, rinse immediately with clean water and ask for medical attention.
- ⚠ At the end of its useful life, please properly discard the Power Jumper according to your environmental regulations.

L. Warranty Information

1. We offer a limited warranty for this product against any defects in material and workmanship for a period of 12 months from the date of purchase by the end user/consumer. The conditions of the warranty are as follows
2. The warranty is only valid upon presentation of the original receipt (from dealer / retailer / etailer) by the original purchaser with the product to be repaired or replaced.
3. The warranty does not cover damage or product failure resulting from normal wear and tear, physical abuse, improper installation, misuse, modification or repairs by unauthorized third parties.
4. Warrant is void if the Q.C. PASSED label is broken / removed.
5. We do not assume responsibility for any loss or damage incurred during shipment or as a result of a force majeure.
6. We are not liable for any incidental or consequential damages arising from the use or misuse of product.
7. All warranty claims are limited to repair or replacement of the defective product and at the sole discretion of us.
8. If we repair or replace the product, the product will be covered for the remaining time of the original warranty period. Repair or replacement may involve the use of reconditioned units which are equivalent in function. Replaced part or product becomes the property of us.
9. Consumable components such as batteries are not covered by the warranty.
10. If the product is in warranty, upon receipt of the product it will either be repaired or exchanged depending on the model. Please allow approximately 2 weeks before contacting Energen for status. If the product is out of warranty, a letter will automatically be sent with information as to the repair charge or replacement charge.

For any questions, please visit us online at www.myenergen.com.

